

## SMD Shielded Tiny Power Inductor Size 8065

- Magnetic resin for higher current and semi-magnetically shielded
- Quantity: 700pcs
- DC/DC converter
- LC filter

Dimensions: [mm]

Land Pattern: [mm]

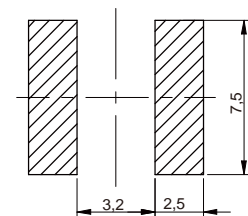

Electrical Properties:

Part No	( $\mu$ H)	Tolerance	Saturation (A)	(A)	( )
NRSE8065-4R7N			8.50	4.70	0.018
NRSE8065-6R8M			7.60	4.30	0.026
NRSE8065-100M			6.60	4.00	0.033
NRSE8065-220M			4.30	2.80	0.054
NRSE8065-3	SE8065-3	-	SE8065-3	SE8065-220M	0.083
			2.85	1.80	0.135
			2.50	1.50	0.181
			2.30	1.40	0.215
			2.00	1.30	0.250
			1.60	1.00	0.360
			1.30	0.90	0.528
			1.00	0.55	1.300
			0.65	0.40	2.350
			0.45	0.27	5.000

Operating temperature:  $-40^{\circ}\text{C} \sim +125^{\circ}\text{C}$

Temperature rise current: the actual value of DC current when the temperature rise is  $\leq 40^{\circ}\text{C}$

Saturation Current that will cause initial inductance to drop approximately 30%